

## FLOOR DOOR

Side B	Side C	Side D	VERSION	H LIGHT	H FRAME	WINDOW	GLASS	ACCESSORIES	C1	C2	PM	PE
1	2		Standard RAL 9016	2000	2100	Panoramic	Transparent			X		

C1 = Enabling key for the floor button pad (single insertion) C2 = Enabling key for the floor button pad (double insertion) PM = Button pad on the wall PE = Outside lock and button pad

### Shaft V315B (Struttura V315B)

ENVIRONMENT	VERSION	CLADDING	START	ROOF	ANCHORAGE
Inside	RAL 9016	Glass Transparent	Pit bottom	For Inside	Anchorage to care of the Customer. Ancoraggio a cura del Committente.
Interno	RAL 9016	Vetro Trasparente	Fondo Fossa	Per interno	

Automatic Control  
2008

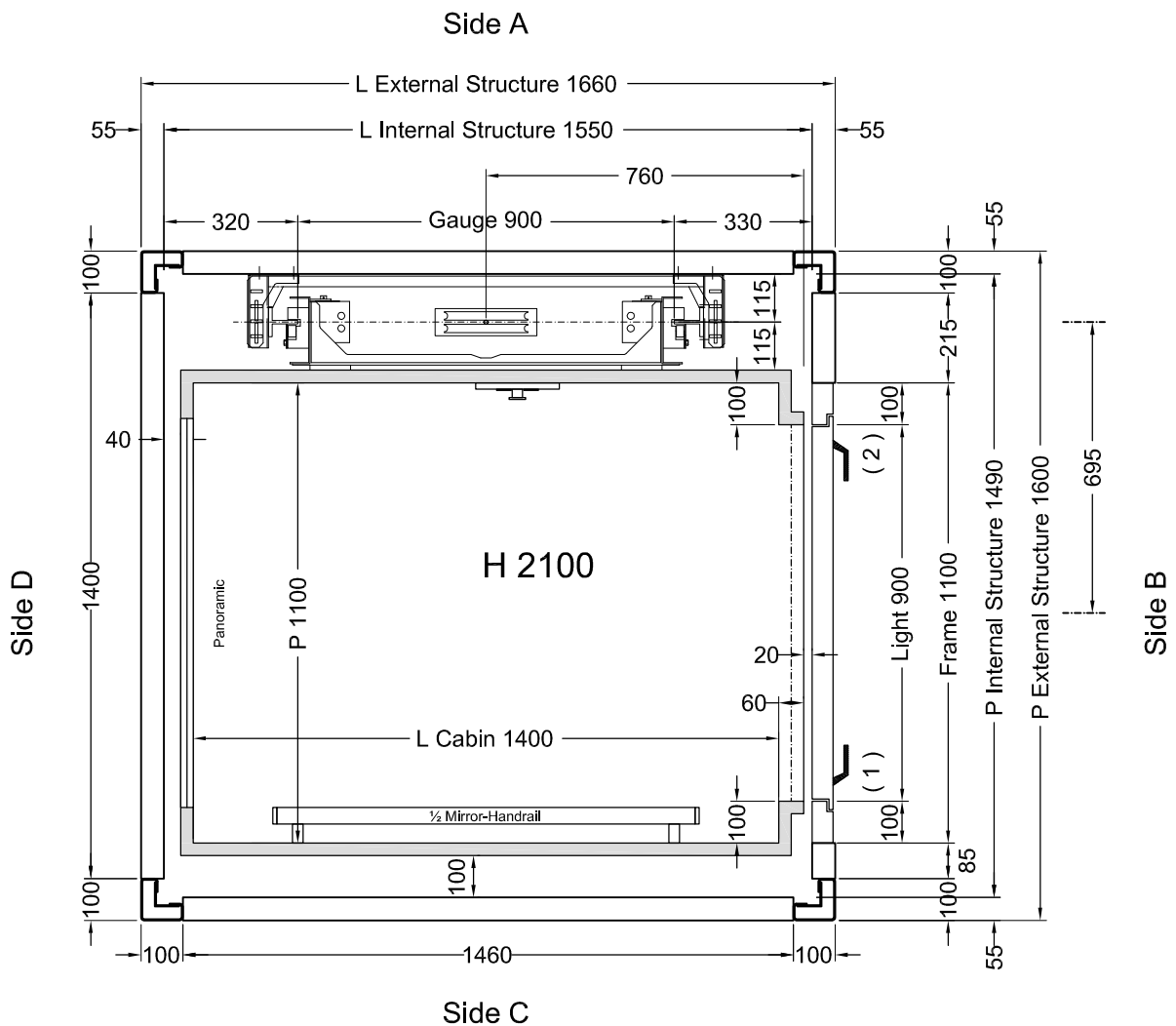

**Stops: 2 - Doors: 2**

Shaft on **Shaft V315B (Struttura V315B)**

	VERSIONS	Description	Designer	Date	Final Design Drawings
○					 SHEET 1/4 SHEET DIMENS. A3 SCALE 1:12.5
○		Modifiche varie.	L.Del Bianco	07/12/2011	
			Final Design Drawings F.Antonelli	1° STESURA 16/06/11	
			CAPACITY 350 kg	AREA m <sup>2</sup> 1,54	CAPACITY 

**ACCESSORI:**

- Chiave abilitazione pulsantiera cabina a doppia estrazione
- Guide in barre da 2,5 m
- Pompa a mano
- Pressostato con segnalazione di sovraccarico
- Doppia velocità
- Interruttore blocco porta quadro
- Dispositivo falsa testata
- Arcata rinforzata
- Fotocellula tutta parete
- Manovra Automatica 2008

Indirect Installation	Speed 0,3 m/s	12/07/11 14.51 (V.2502)			
THRUST DURING NORMAL OPERATION			THRUST OF SAFETY DEVICE INTERVENT.		
P	(N)	11182	P	(N)	461
N	(N)	454	N	(N)	7447
F1	(N)	1781	F1	(N)	2969
F2	(N)	458	F2	(N)	763

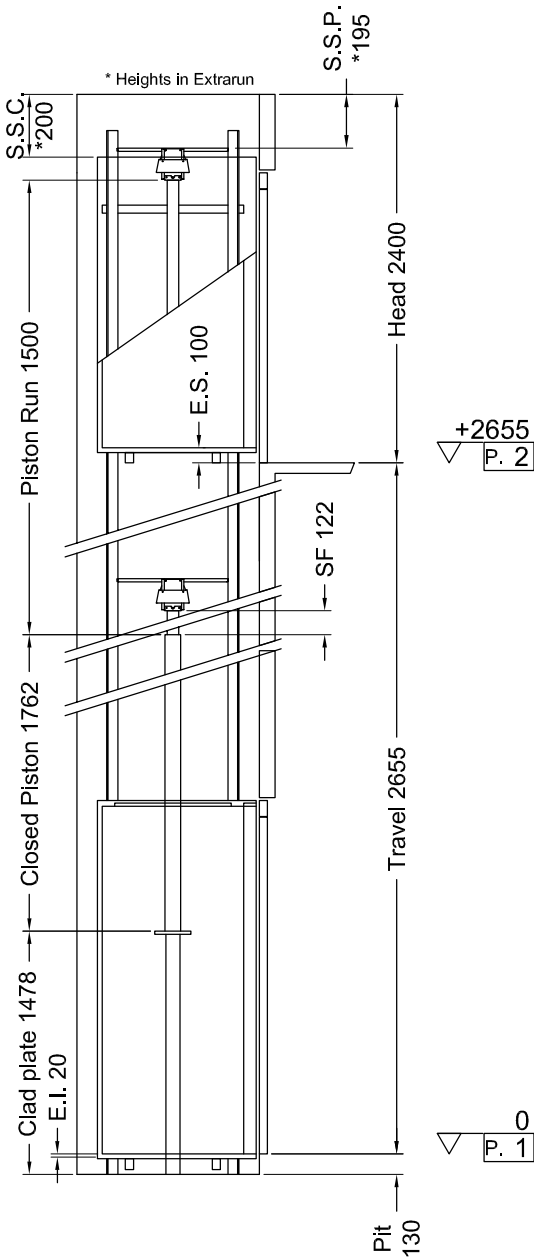
MACHINERY LOCATION			
At floor	1	Length of the hose travel	1000 (mm)
Cables enter in shaft: Side	A		

CABIN		CABIN ACCESSORIES	
Panels	<b>Bianco A1</b>	½ Mirror	<b>Side C</b>
Finishes	<b>Inox BA (Lucido)</b>	Panoramic	<b>Side D</b>
Oper. panel	<b>VERTICAL</b>	Handrail	<b>INOX S.B., Side C</b>
Floor	<b>121-003 - DARK BROWN</b>	Riv. Est.	<b>Side D</b>
Roof	<b>SPOTS LED - Bianco A1</b>	Riv. Esterno	<b>Inox BA (Lucido)</b>

OTHER ACCESSORIES
Enabling key for the cabin button pad, double insertion
Guides dimension 2.5 m
Manual pump
Manostat with overweight signal
Double speed
Cabinet General switcher to enabling controller
False head device
Reinforced arcade
Full height infra-red curtain
Automatic control 2008

The approval of this plan serves also as confirmation of delivery of the masonry manual rev.3.

		Final Design Drawings	1° STESURA
		F. Antonelli	16/06/11
		<b>Final Design Drawings</b>	
	SCALE	OUT OF SCALE	SHEET
			2/4

ENVIRONMENT		VERSION	CLADDING	START	ROOF	ANCHORAGE
Inside	RAL 9016	Glass Transparent	Pit bottom	For Inside	Anchorage to care of the Customer. Ancoraggio a cura del Committente.	
Interno	RAL 9016	Vetro Trasparente	Fondo Fossa	Per interno		

**Shaft V315B (Struttura V315B)**

*Anchorage in height of 3 frames in head and every 3.5 m max*

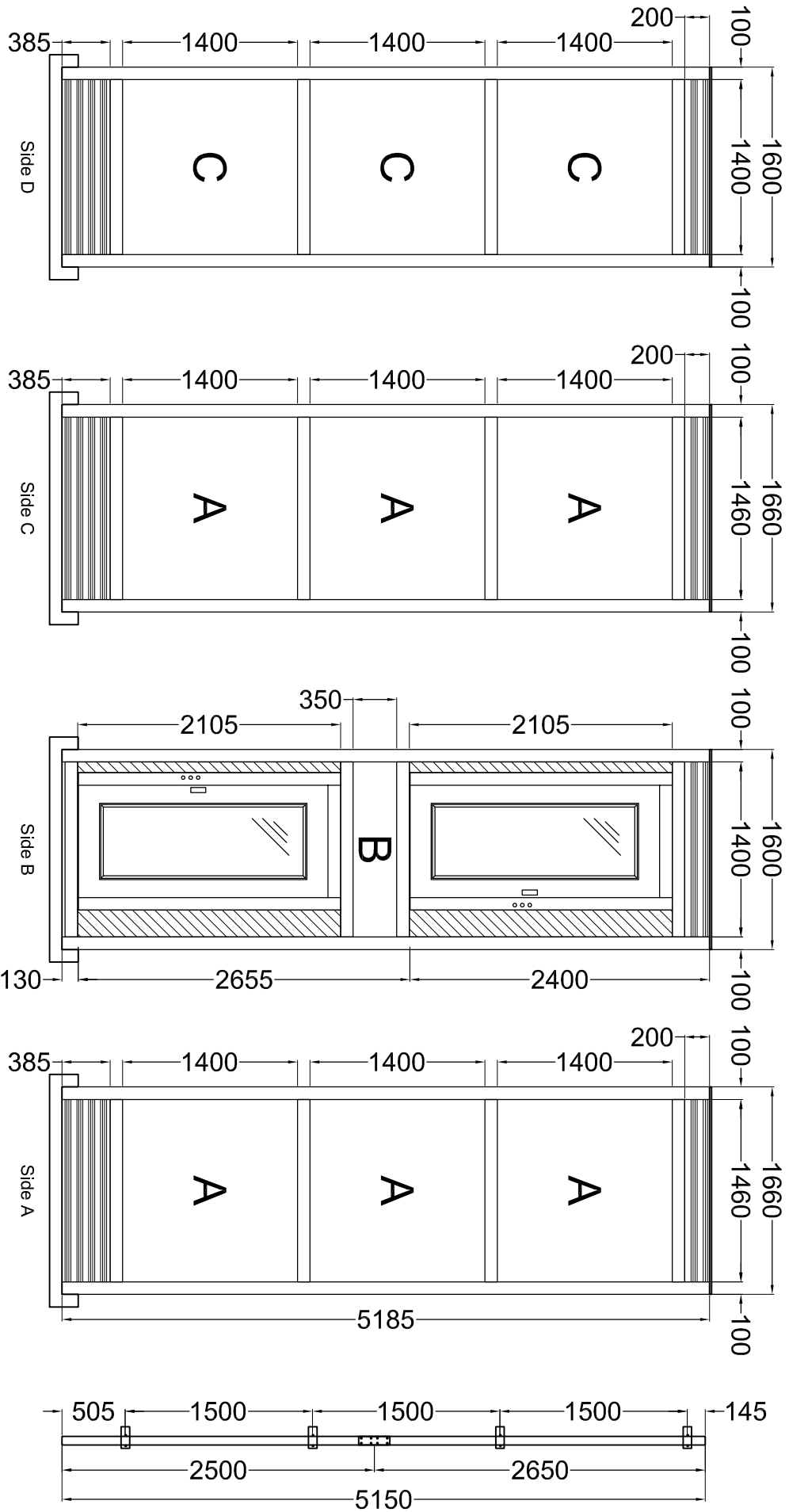

# Cladding

Tag	Q.ty	Type	Thickness	Width	Height
A	6	Glass Transparent	8/9	1480	1430
B	1	Glass Transparent	8/9	1420	380
C	3	Glass Transparent	8/9	1420	1430

