

FLOOR DOOR

Side B	Side C	Side D	VERSION	H LIGHT	H FRAME	FRAME	WINDOW	GLASS	ACCESSORIES
	G	1	Standard RAL 9011 Matt*	2000	2100	RAL 9011 Matt*	Panoramic	Transparent	C2

C1 = Enabling key for the floor button pad (single insertion) C2 = Enabling key for the floor button pad (double insertion) PM = Button pad on the wall PE = Outside lock and button pad

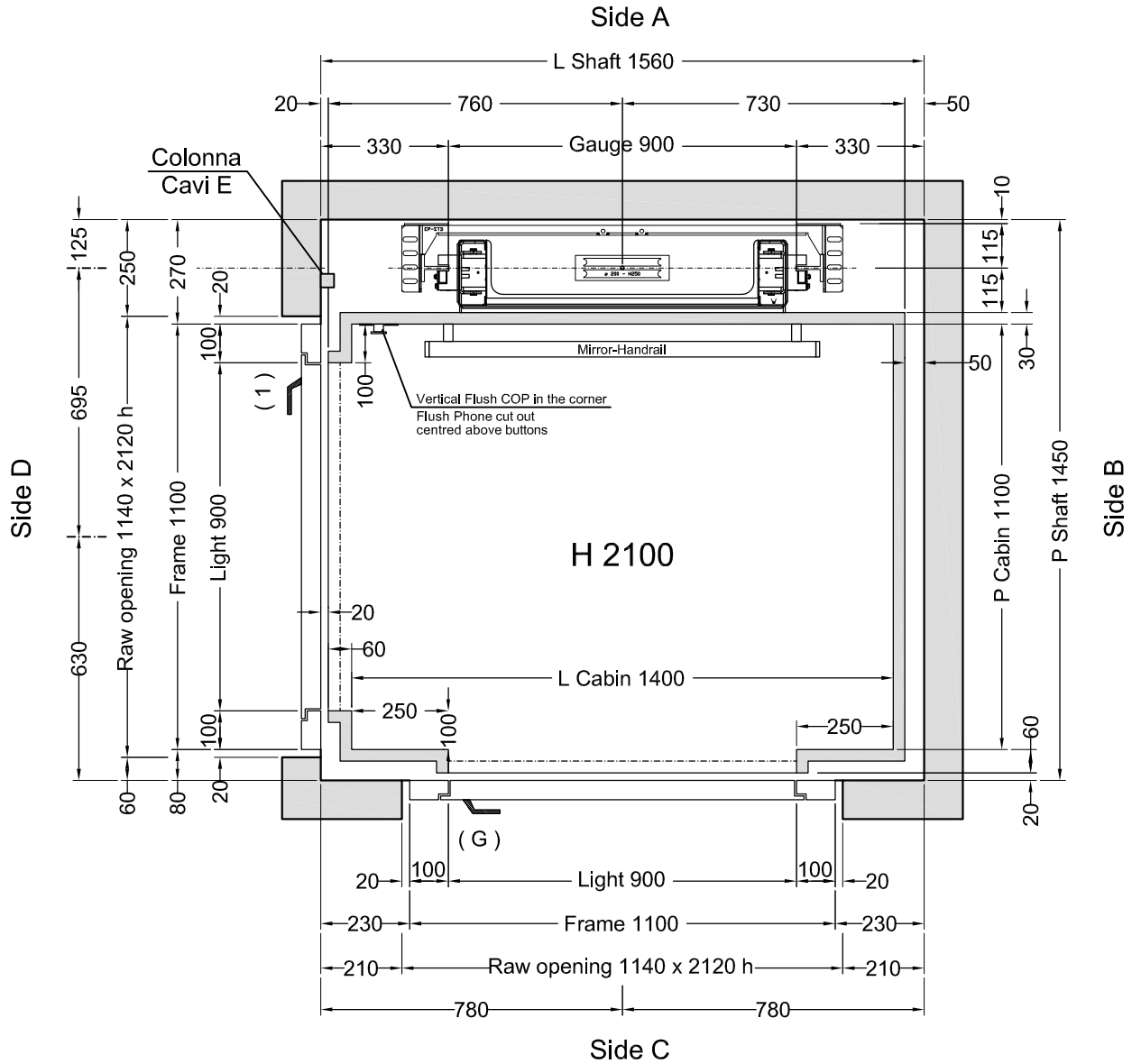

Stops: 2 - Doors: 2

Shaft in **Masonry (Muratura)**

Customer own flooring: Dimensions **1430 (L) x 1130 (P)** thks **20 mm** Weight: **50 kg**

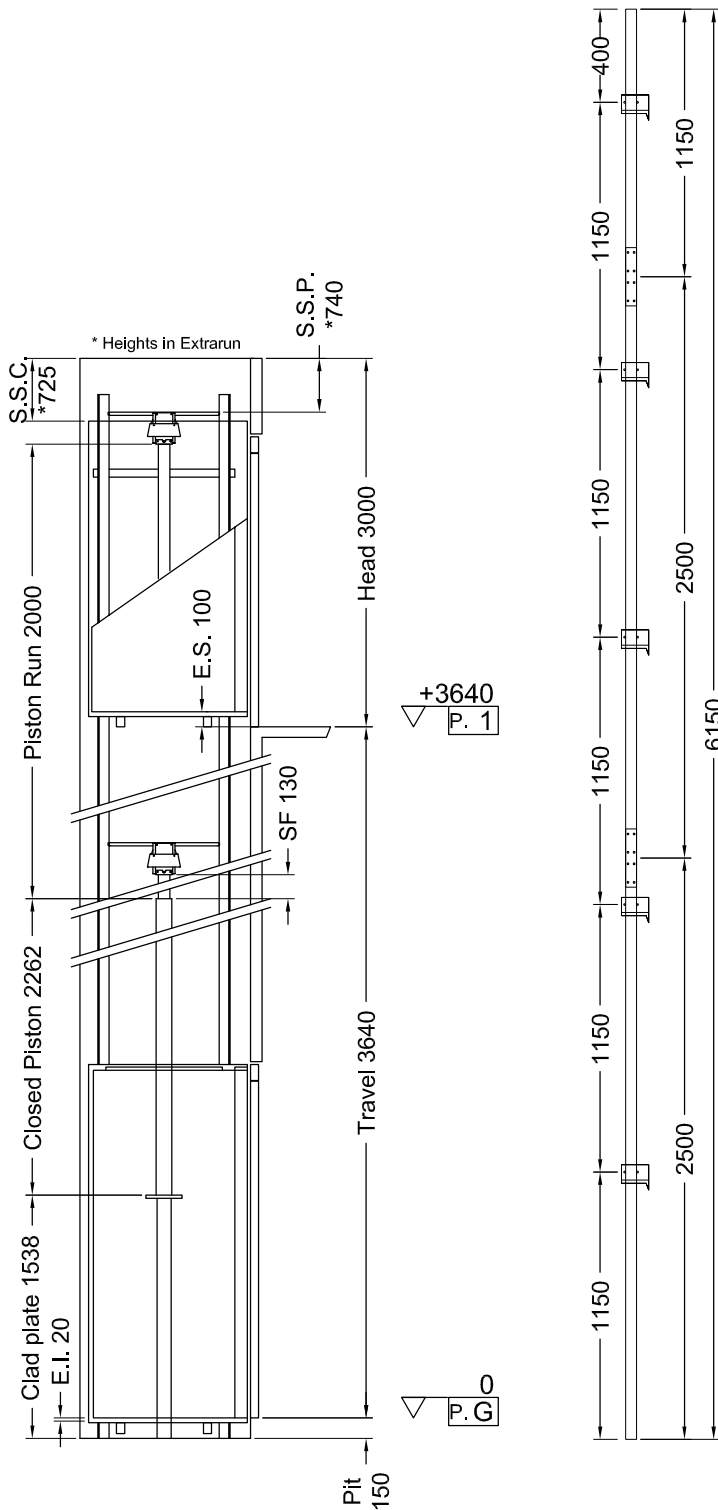

Indirect Installation Speed **0,3 m/s** 30/11/15 10.09 (V.2852)

THRUST DURING NORMAL OPERATION			THRUST OF SAFETY DEVICE INTERVENT.		
P	(N)	12225	P	(N)	501
N	(N)	644	N	(N)	8294
F1	(N)	1718	F1	(N)	2863
F2	(N)	398	F2	(N)	664

SPACES		PRESSURES		
E.I.	Extrarun below cabin (mm)	20	Max static pressure (bar)	36,9
E.S.	Extrarun above cabin (mm)	100	Min static pressure (bar)	21,6
SF.	Piston extraction (mm)	130	Overpressure limit (bar)	51,65
S.S.P.	Piston/head (mm)	740	Residual pressure (bar)	1,3
S.S.C.	Cabin/head (mm)	725		

HYDRAULIC UNIT		MECHANICAL PARTS	
Central unit	GMV HL 3010 (-*)		
Capacity (l/min)	35	Guide rails	70x70x9
Motor (V)	TF400V	Brackets	(Nr) 5
Power (Kw)	2,9	Ropes	Ø 9 mm 6-(1+9+9)
Nominal current (A)	11	Cables length (mm) 2 x	9000
Piston	Start Home (Ø)70x5x2000	Min actual breaking load (N)	47300
Opt. oil position	BASSO		
Tubing	3/4" EN 853 1SN - FD 3/4" - GOMITO 3/4"		
Tubing length (mm)	6000		
Min hydraulic oil (L)	40		

SECURITY DEVICES	Manufacturer	Model	Certificate
Safety Gear	PFB	BP1	TÜV AFV515
Block Valve	START ELEVATOR	1/2" 0327	CA50.00525
Key Locks	Prudhomme	PLT/L/CPX NL 11-400-1002-125-02	

MACHINERY LOCATION			
At floor	G	Length of the hose travel	1000 (mm)
Cables enter in shaft: Side	B		

CABIN		CABIN ACCESSORIES	
Panels	Arpa 0509 Fin Erre	Mirror	Side A
Finishes	Inox Scotch Brite	Handrail	Inox S.B., Side A
Oper. panel	Vertical Flush mounted **	Outside covering	Roof
Floor	By Customer	Outside finishing	F41PPS
Ceiling	SPOTS LED - F41PPS		
(**) Corner A/D - <i>Inox Scotch Brite</i>			

- OTHER ACCESSORIES**
- Enabling key for the cabin button pad, double insertion
 - Guides dimension 2.5 m
 - Manual pump
 - Manostat with overweight signal
 - Two speed
 - Handles CASPIM (Long)
 - Telephone by **Lift Shop**
 - Full height Infra-red curtain V2
 - Power supply 400V 3 phase
 - Roof covering
 - Automatic Control 2011
 - Call Accept + Emergency manual descent from cabin
 - Cut out for flush phone 86 mm x 175 mm centred above buttons on COP

