

FLOOR DOOR

Side B	Side C	Side D	VERSION	H LIGHT	H FRAME	FRAME	WINDOW	GLASS	ACCESSORIES
B G 1 2			2 Panels F41PPS	2000	2100	F41PPS	Absent		C2 - PM

C1 = Enabling key for the floor button pad (single insertion) C2 = Enabling key for the floor button pad (double insertion) PM = Button pad on the wall PE = Outside lock and button pad

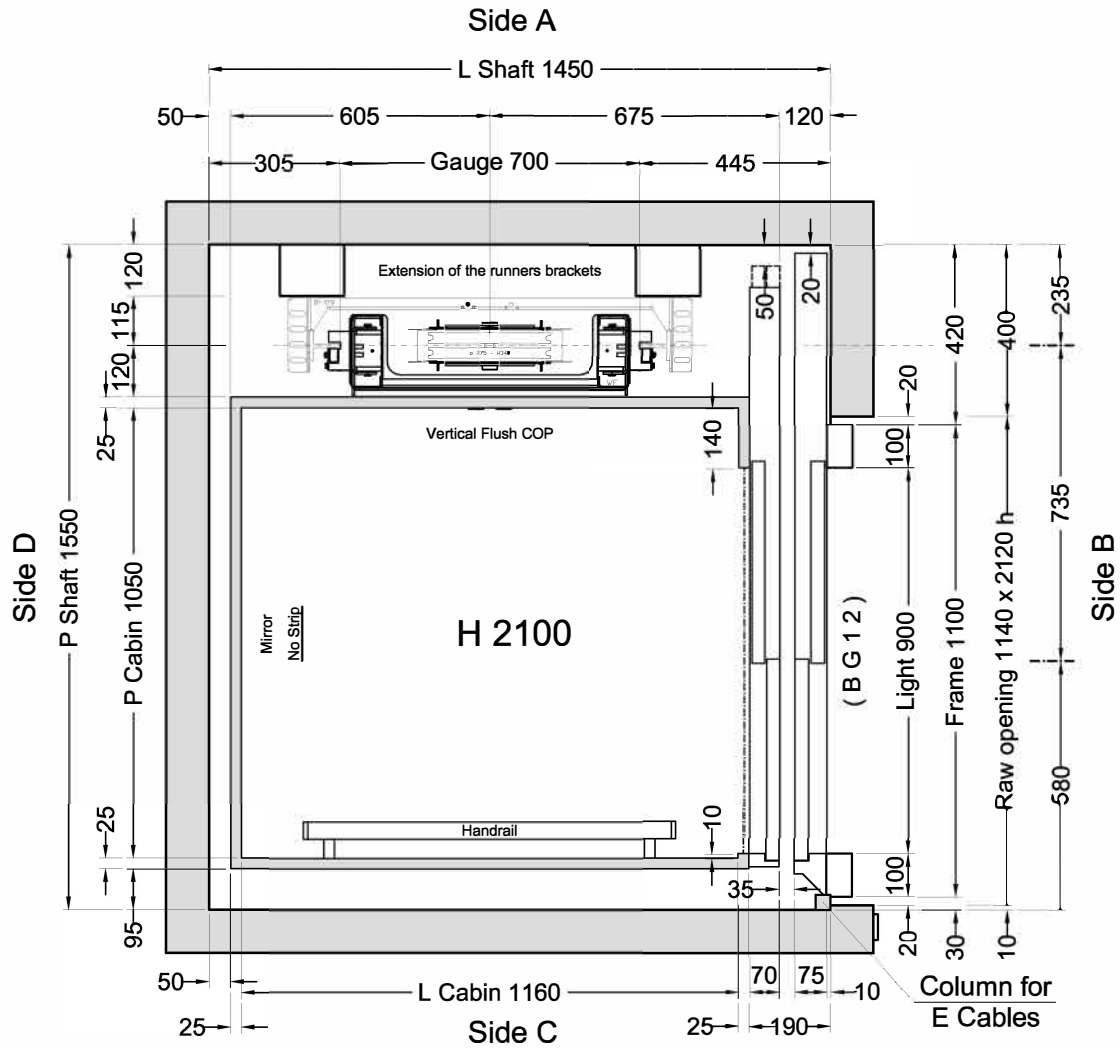

Cabina
Classica

Stops: 4 - Doors: 4

Shaft in **Reinforced concrete (C.A.)**

Customer own flooring: Dimensions **1185 (L) x 1050 (P)** thks **20 mm** Weight: **50 kg**

ORDER	VERSIONS	Description	Designer	Date	Final Drawings	
ORDER NUMBER	E	testata era 3550.	D.Tomei	08/06/2016	Model ELFO 2	SHEET 1/2
	D	Pulsantiere di piano a murare.	L. Del Bianco	30/05/2016		
	C	L Vano era 1600 con L Cabina 1280.	D.Tomei	27/04/2016	SHEET DIMENS. A3	
	B	H Telaio 2100 mm.	L. Del Bianco	21/04/2016		
			Final Drawings L. Del Bianco	1° STESURA 16/06/16		SCALE 1:12.5
			CAPACITY 350 kg	AREA m² 1,22		CAPACITY

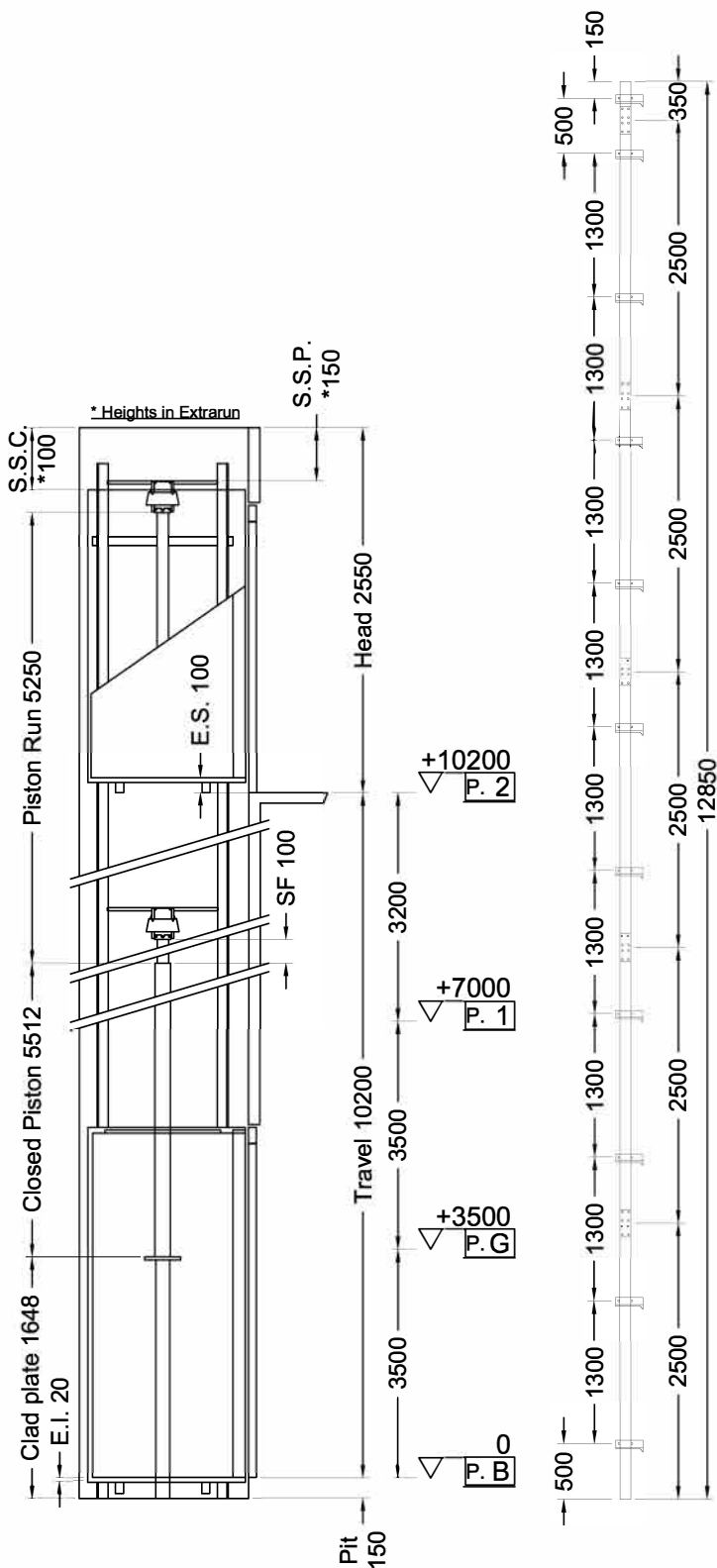

Indirect Installation Speed 0,3 m/s 16/06/16 17.58 (V.2891) ^{EN}

THRUST DURING NORMAL OPERATION			THRUST OF SAFETY DEVICE INTERVENT.		
P	(N)	13319	P	(N)	1154
N	(N)	1224	N	(N)	8949
F1	(N)	1514	F1	(N)	2524
F2	(N)	282	F2	(N)	471

SPACES		PRESSURES		
E.I.	Extrarun below cabin (mm)	20	Max static pressure (bar)	43,6
E.S.	Extrarun above cabin (mm)	100	Min static pressure (bar)	25,76
SF.	Piston extraction (mm)	100	Overpressure limit (bar)	61,04
S.S.P.	Piston/head (mm)	150	Residual pressure (bar)	3
S.S.C.	Cabin/head (mm)	100		

HYDRAULIC UNIT		MECHANICAL PARTS	
Central unit	GMV HL 3010 (-*)		
Capacity (l/min)	35	Guide rails	70x70x9
Motor (V)	MF230V	Brackets	(Nr) 11
Power (Kw)	3,4	Ropes	Ø 11 mm 6-(1+9+9)
Nominal current (A)	32	Cables length (mm) 2 x	16000
Piston Start Home	(ø)70x10x5250	Min actual breaking load (N)	70700
Opt. oil position	BASSO		
Tubing	3/4" EN 853 1SN - FD 3/4" - GOMITO 3/4"		
Tubing length (mm)	5000		
Min hydraulic oil (L)	56		

SECURITY DEVICES	Manufacturer	Model	Certificate
Safety Gear	PFB	BP1	TÜV AFV515
Block Valve	START ELEVATOR	1/2" 0327	CA50.00525
Key Locks	FERMATOR	210/10/40	

MACHINERY LOCATION			
At floor	B	Length of the hose travel	1000 (mm)
Cables enter in shaft: Side	A		

CABIN		CABIN ACCESSORIES	
Panels	F41PPS	Mirror	No Strip Side D
Finishes	Inox Scotch Brite	Handrail	Inox S.B., Side C
Oper. panel	Vertical Flush mounted - Inox Scotch Brite		
Floor	By Customer		
Ceiling	SPOTS LED - F41PPS		
Cabin Doors	Side B: 2-Panels Automatic Sliding doors, F41PPS		

OTHER ACCESSORIES

- Enabling key for the cabin button pad, double insertion
- Guides dimension 2.5 m
- Piston in 2 pcs
- Manual pump
- Manostat with overweight signal
- Two speed
- Return to the lower floor after adjustable time
- False head device
- Telephone by Lift Shop
- Full height infra-red curtain V2
- Floor Button Pad fixed to the Wall
- Automatic Control 2011
- Call Accept + Emergency manual descent from cabin
- Cabin Buttons: "B, G, 1, 2"
- Door Open Button on C.O.P.



ORDER
ORDER NUMBER

CLIENT

Final Drawings
L. Del Bianco
1° STESURA
16/06/16

Final Drawings
SCALE
OUT OF SCALE

SHEET
2/2